

TOROIDAL CURRENT TRANSFORMERS

Model 8 Ratio to 0.08 (Window Size: 3.25" Dia.)

Application: Metering

Frequency: 50-400 Hz

Insulation Level: 600 Volts, 10Kv BIL Full Wave

Standards: CSA 66.1-06, CSA 66.2-06, IEEE C 57.13, and UL 506

- Flexible leads available for all case configurations. Flexible leads are UL 1015 105°C, C.S.A approved #16 AWG, 24" long standard length. Non-standard lengths are available upon request.
- Approximate weight: 3 lbs.



8RL

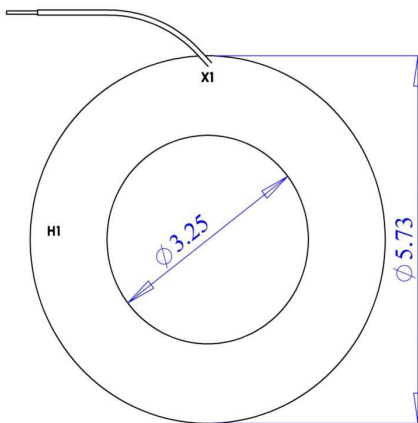
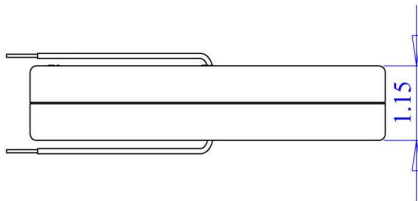

Current Ratio	ANSI Metering Class at 60 Hz.					Continuous Thermal Rating Factor	
	B0.1	B0.2	B0.5	B0.9	B1.8	at 30°C	at 55°C
1200:0.08	0.15	0.15	0.15	0.15	0.15	2.0	2.0

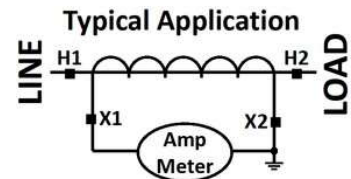

Rev A 10 10 2024